

X3 Max Zipperless Upper Doors (KIT) Part# 2005020011

Congratulations on your purchase of the Zipperless Upper Doors for your Can-Am Maverick X3 Max. Please familiarize yourself with the hardware and instructions below before attempting installation to get the most out of your Tusk product.



For detailed video instructions please visit www.rockymountainatvmc.com

Vehicle Fitment

Can-Am Maverick X3 Max (2017-2021)

Hardware

- RH Front Filler (1)
- LH Front Filler (1)
- RH Rear Filler (1)
- LH Rear Filler (1)
- RH Front Zipperless Door Skin (1)
- LH Front Zipperless Door Skin (1)
- RH Rear Zipperless Door Skin (1)
- LH Rear Zipperless Door Skin (1)
- M6 x 30mm Button Head Bolt (22)
- M6 Washer (26)
- M6 Nylon Locking Nut (26)
- O-Ring (28)
- 15/64" Aluminum Spacer (22)
- Loop Clamp (22)
- Disc Magnet (14)
- Adhesive Tape Circle (14)
- Foam Tape Strips (1)
- Self Tapping Snap (22)
- M6x70mm Button Head Bolt (4)
- M6x90mm Hex Head Bolt (4)
- 3/8" Black Spacer (4)



Front Door Skin (Driver Side Shown)



Rear Door Skin (Driver Side Shown)



Front and Rear Filler Panels (Driver Side Shown)



(22) Loop Clamps



(22) M6 x 30mm Button Head Bolt



(26) M6 Nyloc Nut and M6 Washer



(14) Adhesive Tape Circle and Disc Magnet



(28) O-Ring
Extra's included

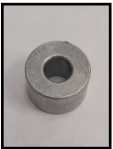

(22) 15/64" Spacer



(1) Foam Tape Strips



(22) Self Tapping Snaps



(4) M6 x 90mm Hex Head Bolts (Tusk Accessories)

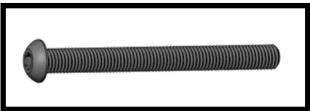

(4) M6 x 70mm Button Head Bolts (Filler Holes)

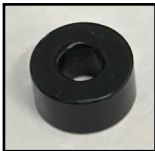

(4) 3/8" Spacer (Mirror Spacers)

Filler Panel Preparation

We have found install of the Tusk Zipperless Upper Doors is easier done with other accessories off the machine. This includes light bars, mirrors, grab handles, roofs, rear windows, and front windshields. These accessories can be reinstalled once the upper door install is complete. For a smooth fit, windows should be installed at temperatures above 72° F. Below this temperature, the fabric with contract.

1. Begin installation by wiping down the inside of the filler panel with isopropyl alcohol to prepare it for adhesive foam tape.
2. Place the foam tape around the outside perimeter of each filler panel as shown in **FIG 1**. This foam tape should seal the filler panels to the roll cage.
3. Finish preparation of the front and rear filler panels for installation. Start by passing a M6 x 30mm button head bolt through a M6 washer and then into the filler's bolt holes. Pass a 15/64" aluminum spacer over the bolt followed by an O-ring. The O-ring serves to hold the bolt and spacer onto the bolt as you line the filler up with the clamps placed on the cage. Repeat this process for all mounting holes for all of the filler panels. **FIG 2**
4. The loop clamps can now be installed. 5 loop clamps are used to secure the front filler panel. 6 will be used to secure the rear filler panel. Place the loop clamps in their approximate location with the flat side facing out, away from the machine. **FIG 3 & 4**



Filler Panel Installation

- Next, locate the front upper filler panels, these panels will be fitted to the machine using the 5 loop clamps. **FIG 5**
- With the loop clamps passed over the frame, loosely install the front filler panel to the loop clamps with a provided nyloc nut.
- Verify alignment of the loop clamps with the filler panel bolts and adjust the clamps as needed. Once all are aligned, **loosely** install bolts and washers in remaining holes. All bolts in loop clamps should go through a washer, then the filler, then the spacer, then the O-Ring, then both sides of a loop clamp, and be secured with a nyloc nut. **FIG 6**

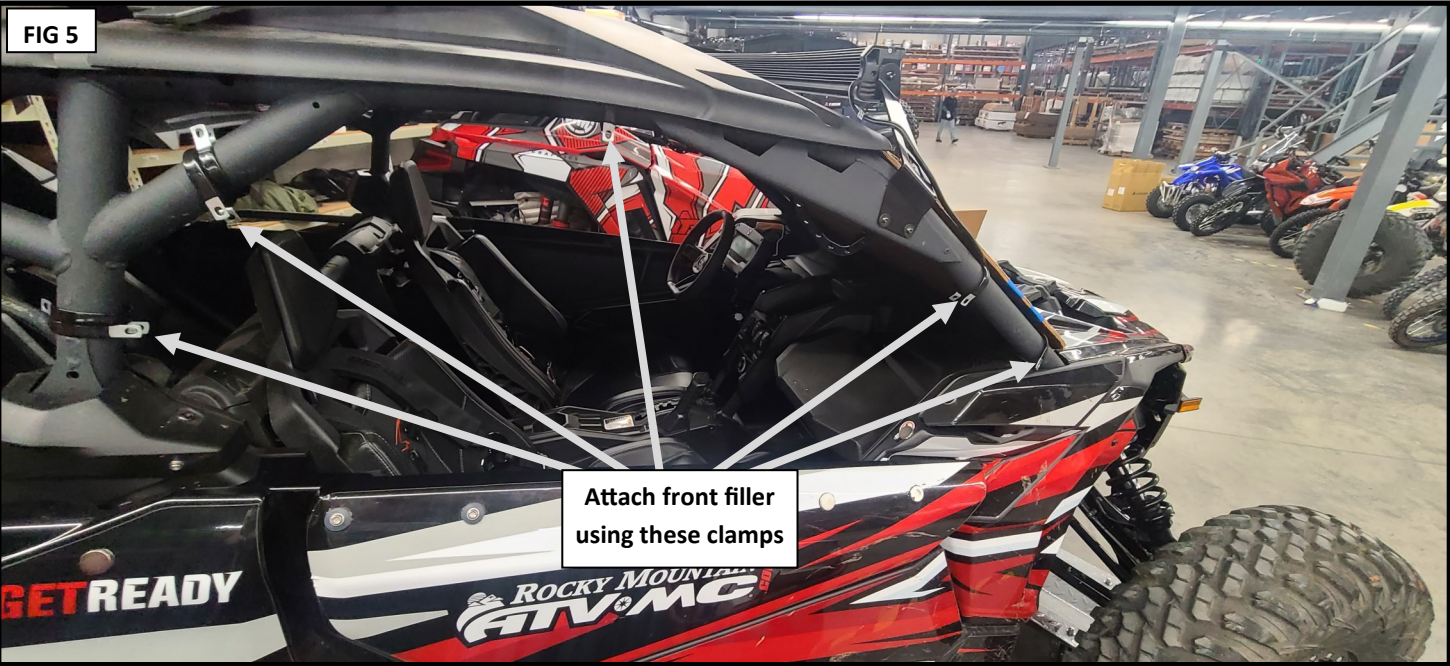

Rear Filler Panel Installation

8. Next, locate the rear upper filler panels, these panels will be fitted to the machine using the 6 loop clamps. **FIG 7**
9. Verify alignment of the loop clamps with the filler panel bolts and adjust the clamps as needed. Once all are aligned, loosely install nyloc nuts on all filler panel bolts.
10. Next, align the front and rear filler panels so that the foam tape you installed in snug against the roll cage. Once you are satisfied by the fit of all filler panels you can tighten all mounting bolts starting at the rear. **FIG 8**
11. Repeat steps 1-10 for the opposite side.



Door Skin Installation

12. With all the filler panels tightly installed, it is time to install the door skins. Attach the magnets on the top of each filler panel to the magnets in the door skin, let the rest of the door skin hang. Do this for both front and rear of the machine. **FIG 9**
13. Next, locate the **short** hook and loop straps along the back edges of the doors. Secure the rear section of each door using the hook and loop straps around the notches cut into the filler panels. **FIG 10**
14. The long straps are used to hold the windows while rolled up. The longer straps can be tucked in-between the filler panel and the door skin. **FIG 11**
15. Repeat steps 12-14 for the opposite side.

*****NOTE:** Be sure you are satisfied with magnet alignment on the front and rear doors.
This is critical for the remainder of the installation.



Snap Installation

16. With the door skins attached to the rear of the filler panel, and the magnets all attached you are ready to install the snaps.

Note: adhesive style snaps are available as an alternate to self tapping snaps (Part #210452)

IMPORTANT NOTICE

Due to the nature of vinyl windows, the windows will shrink in the cold. You must leave room for the windows to shrink (**approximately 1"**). If windows are too loose, they may flap at high speeds and detach from magnets. If windows are too tight, the window magnets will not reach the filler panel magnets.

17. Let the fabric door skin rest on the door and then move 1" upward to find the installation location. You will you will need to mark the spots to install the threaded snaps. We find using a piece of duct tape or a few layers of masking tape can be used to find the location. Stick a piece of tape on the machine in the approximate location. Press the door side of the snap onto the piece of tape. This should leave an outline of where the snap is located **FIG 12**. The center of the outline can be approximated for the appropriate drilling location.

18. With the snaps marked, the self tapping snaps can be threaded into the machine. Make sure to keep constant pressure on the snap to tap itself in nicely. **FIG 13**

Note: We have found it best to start in the middle and work outwards

19. Once all snaps are installed, Locate the double sided adhesive sticker and the disc magnet. Attach the magnet to the door skin and attach the adhesive sticker disc to the back side. **FIG 14**

20. Remove the adhesive backing and attach the disc magnet to the body of the machine.

21. Repeat steps 16-20 for opposite side of the machine.



Accessory Installation

22. Installation with Tusk Folding Mirrors:

Begin installation by passing the provided M6x90mm bolts through a M6 washer and then through the mirror brackets. Pass a 3/8" black spacer over the bolt. Pass the bolts through the filler panel (If installing with Tusk Light Bar, pass the light bar bracket on the bolts now), then through the roll cage gusset, and secure with a M6 nyloc nut from the inside of the machine. **FIG 15**
Repeat steps for other side.

23. Installation without Mirrors:

Pass the provided M6x70mm bolts through a washer before bolting through the filler panel and roll cage gusset. (If installing with Tusk Light Bar, pass the light bar bracket on the bolts after passing through the filler panel, before the roll cage gusset). Secure with a M6 nyloc nut from the inside of the machine. **FIG 16**
Repeat steps for other side.

24. Reinstall other accessories that may have been removed or loosened during installation.



All 4 sides of the Tusk Zipperless Doors easily roll to the back of the machine when not in use. This is done by releasing all snaps, releasing all magnets, and rolling the soft skins towards the back of the machine. Use the two long hook and loop straps to secure doors. **FIG 17**

Please take note of the caution label on the inside of the door. These door are not intended to be "Unrolled" or "In use position" on the machine if transporting on an open trailer. Please be sure they are in the rolled "Stowed" position during transport.

NOTE: When storing doors for a period of time, it is best to have the Zipperless Upper Doors unrolled. Because of the nature of the clear poly vinyl it has memory of shape. If door is rolled tight for an extended period of time, It will take a time for door to return back to its original shape.

